



22 Glyde Street South Perth, WA



3



1



2

## Perfect Picturesque Location

First Home Open Saturday 14 January from 11.00 am to 12.00 pm.

Nestled high on the hill in a quite tree lined street is this spacious three bedroom, one semi-ensuite bathroom villa with an elegant garden front and back. The lawns and gardens are reticulated off a shared bore.

The central kitchen overlooks a large living dining area, with a reverse cycle split system, and opens onto a balcony with a spectacular view of the street scape. The balcony is protected from the weather by the leafy street trees and has a remote-control blind which aids in blocking the setting sun.

A laundry behind folding doors is also located just off the meals area adjacent to the kitchen.

Great location close to the river, golf course, supermarkets, schools, transport, and restaurants.

**Council Rates:** \$1,999.00/year (approx)

**Water Rates:** \$1,130.00/year (approx)

**Strata Rates:** \$750.00/year (approx)

**Greg St Quintin**

0411596835

**John Szkirpan**

0403069733

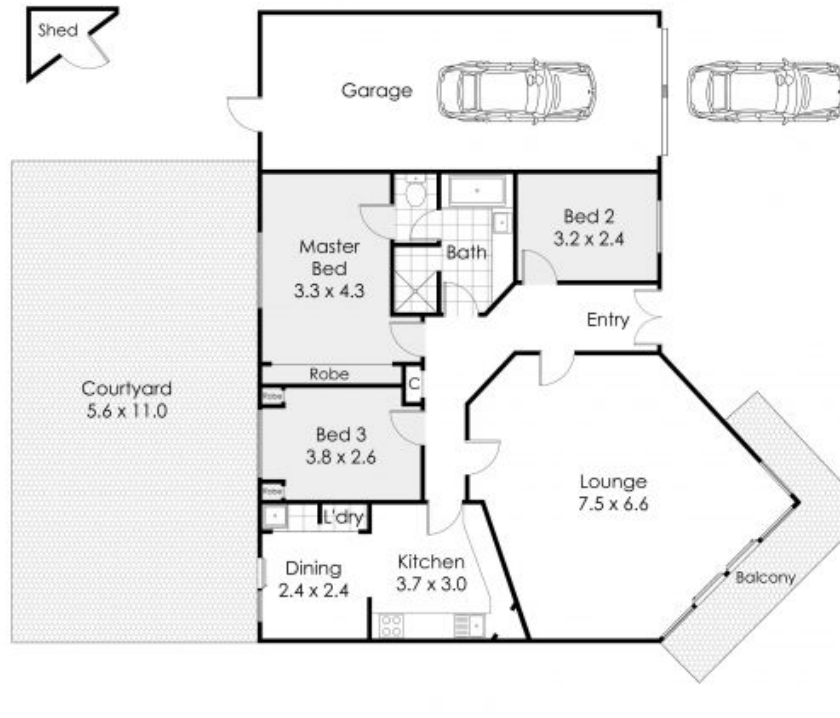

## 22 Glyde Street, South Perth

This floor plan is not to scale.  
 Dimensions are approximate and therefore should only be used for illustrative purposes.

-  210 m<sup>2</sup>
-  2 Bed
-  1 Bath
-  2 Car